

Item No. 215058 - 4 Prong (Richter) Adapter Plate with Tilt Swivel



Compatible with:

Becker Traffic Assist Highspeed 7934
Becker Traffic Assist Pro 7926
Becker Traffic Assist Pro 7927
Becker Traffic Assistant 7914
Blaupunkt TravelPilot Lucca 3.5
Blaupunkt TravelPilot Lucca 5.2

Blaupunkt TravelPilot Lucca 5.3
Clarion MAP 360
Clarion MAP 370
Clarion MAP 560
Clarion MAP 670
Clarion MAP 770

Cobra NavOne 4500
Falk 3500 PRO SC
Falk E60
Falk N100
Falk N120
Falk N150

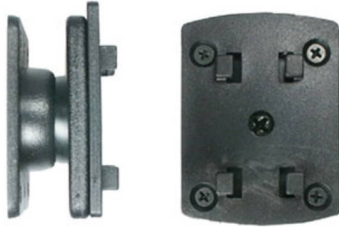

Warnings:

Carefully read all instructions and review the images before attaching.

Do not attach anything to the mount until after attaching the mount to the dashboard. Doing so makes it more difficult to attach the mount to the dash. **Please note:** If you screw into the mount it will be considered used and therefore non-refundable.

The ProClip mount and/or holder in the installation pictures may look slightly different from the one you have received. However, the same instructions apply. If you have questions call our customer service at **1-800-296-3212** or **+1-847-388-7171**.

ProClip USA, Inc. may not be held liable for any personal injury or damage to a vehicle or device, resulting from accident or improper use or installation, before, during or after the installation or removal of this mount and/or holder.



1. Unscrew the screw in the center of the mounting plate and remove the mounting plate from the Tilt Swivel base plate.

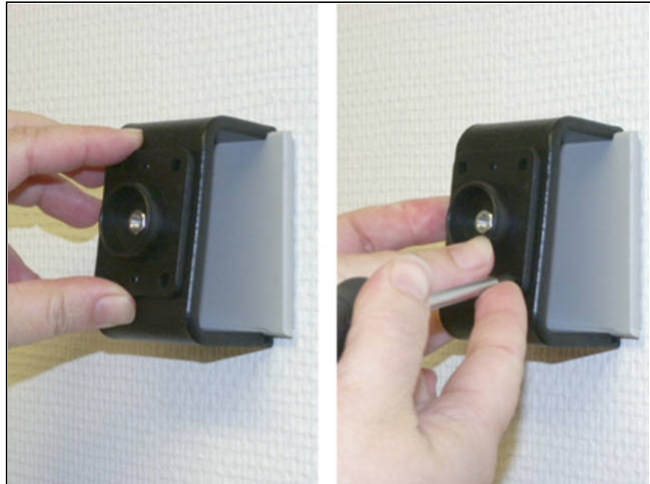

2. Place the Tilt Swivel base plate over the matching holes in your mounting bracket (demo ProClip mount shown in picture) Attach the base plate by using the applicable screws enclosed

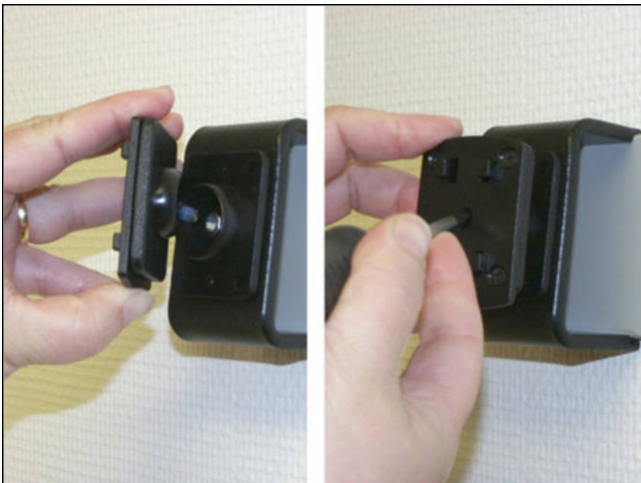

3. Place the mounting plate onto the Tilt Swivel base plate and attach it with the center screw. This screw also controls the pivot, tighter for a firm hold and loose for more (easier) movement/angling of the mounting plate.

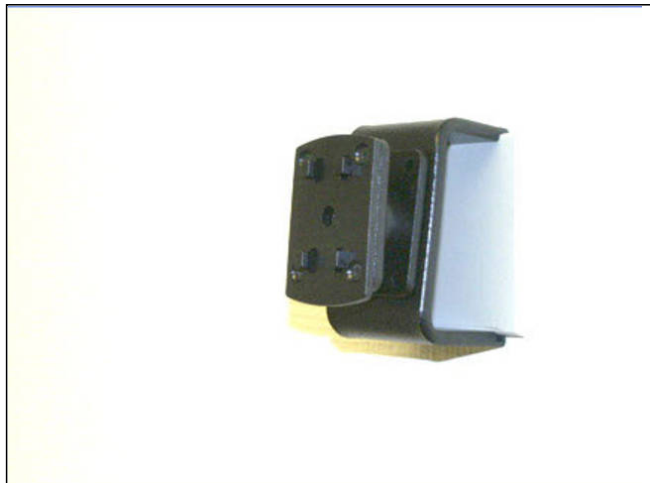

4. Now that the plate is in place, find your device cradle, which is usually enclosed with your device when purchased. Attach your device cradle to your device, then hook the device with the cradle onto the T prongs and slide it down. If you don't have a cradle, hook your device onto the T prongs and slide it down. To remove it, slide the device up and unhook it from the T prongs.