

Compatible with:

Sony NW-HD1



Warnings:

Carefully read all instructions and review the images before attaching.

The product in the installation pictures may look slightly different from the one you have received. However, the same instructions apply. If you have questions call our customer service at **1-800-296-3212** or **+1-608-807-5320**.

ProClip USA, Inc. may not be held liable for any personal injury or damage to a vehicle or device, resulting from accident or improper use or installation, before, during or after the installation or removal of this product.



1. Unscrew the screw in the center of the holder and remove the holder from the Tilt Swivel base plate.

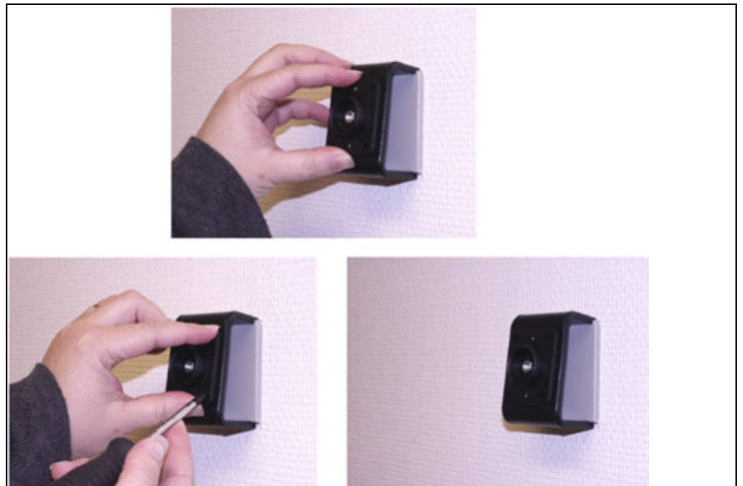

2. Place the base plate over the matching holes in your mounting bracket (demo ProClip mount shown in picture) Attach the base plate by using the self-tapping screws. Note: The machine screws with nuts are for mounts made of metal with large holes.



3. Start to thread the center screw into the base plate. When you connect with the nut pull the holder towards you to prevent the nut from spinning around. Continue to tighten the screw firmly. Then loosen the screw slightly for easier angling/rotation of the holder.

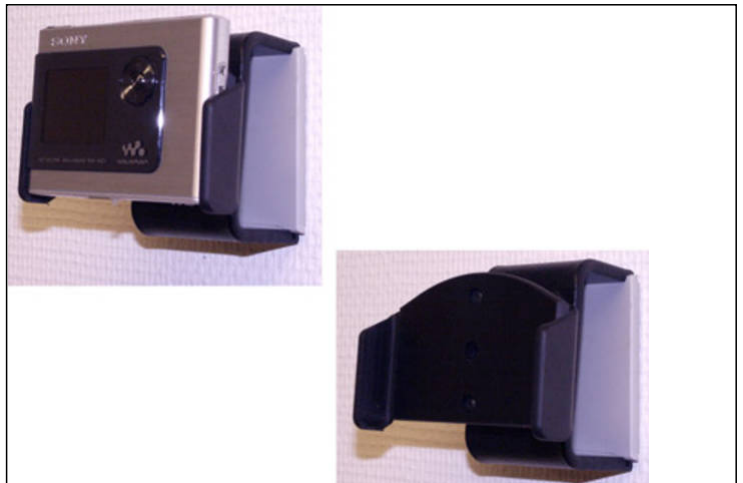

4. The holder is in place.