

Compatible with:

Apple iPhone 1st Generation
 Apple iPhone 2nd Generation (3G)
 Apple iPhone 3G
 Apple iPhone 3GS
 Apple iPhone 3rd Generation (3G)
 Apple iPhone 3rd Generation (3GS)

Apple iPod Touch 1st Generation
 AT&T Apple iPhone 3G
 AT&T Apple iPhone 3GS
 AT&T BlackBerry Curve 8310
 AT&T BlackBerry Curve 8320
 BlackBerry 8300

BlackBerry 8310
 BlackBerry 8320
 BlackBerry 8330
 BlackBerry 9630
 BlackBerry 9630
 BlackBerry Curve 8300



Warnings:

Carefully read all instructions and review the images before attaching.

Do not attach anything to the mount until after attaching the mount to the dashboard. Doing so makes it more difficult to attach the mount to the dash. **Please note:** If you screw into the mount it will be considered used and therefore non-refundable.

The ProClip mount and/or holder in the installation pictures may look slightly different from the one you have received. However, the same instructions apply. If you have questions call our customer service at **1-800-296-3212** or **+1-847-388-7171**.

ProClip USA, Inc. may not be held liable for any personal injury or damage to a vehicle or device, resulting from accident or improper use or installation, before, during or after the installation or removal of this mount and/or holder.



To adjust the Holder to your unit: Loosen the screws on the back side of the holder, so the sides of the Holders can be adjusted. Place the unit in the Holder and press the sides together so the unit is firmly in place. Screw on the screws on the back side of the Holder.



To install the Holder: Unscrew the screw in the center of the Holder and remove the mounting plate from the Tilt Swivel base plate. Place the Tilt Swivel base plate over the matching holes in your mounting bracket (demo ProClip mount shown in picture) Attach the base plate by using the applicable screws enclosed

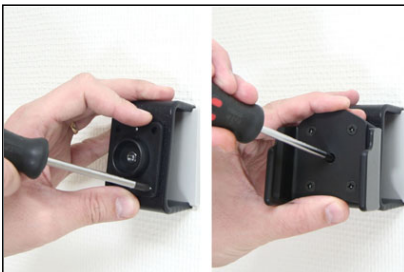

Place the Holder onto the Tilt Swivel base plate and attach it with the center screw. This screw also controls the pivot, tighter for a firm hold and loose for more (easier) movement/angling of the mounting plate.



The Holder in Place.

Slide the device down into the Holder. To remove the device from the Holder, slide it up and out.